

COLORI / COLORS

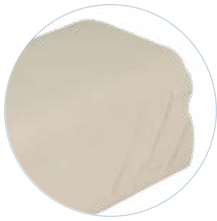









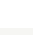

Scalanatura laterale
gocciolatoio

Beccuccio uscita gocciolatoio
chiuso



SCHEDA ORDINE PRODOTTO / PRODUCT ORDER DATA SHEET

COD.	MOD.*					
GOC23-01	23x8 chiuso		36	576	100x120x120	1,184 kg/pz
GOC23-02	23x8 chiuso		36	576	100x120x120	1,184 kg/pz
GOC23-03	23x8 chiuso		36	576	100x120x120	1,184 kg/pz
GOC27-01	27x8 chiuso		21	336	100x120x120	1,608 kg/pz
GOC27-02	27x8 chiuso		21	336	100x120x120	1,608 kg/pz
GOC27-03	27x8 chiuso		21	336	100x120x120	1,608 kg/pz

*MEASURES IN CENTIMETERS

SCHEDA TECNICA PRODOTTO / TECHNICAL SHEET

MOD.*	A*	B*	L*	L1*	H*
23x8 chiuso	7,5	6,5	24	23	9
27x8 chiuso	7,5	6,5	17,5	27	9

*MEASURES IN CENTIMETERS

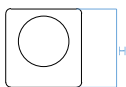
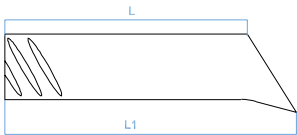
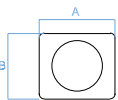

GOCCIOLATOIO IN MARMORES CHIUSO

Commercializzato da GRUPPO STAMPLAST è disponibile nella versione “chiusa” in grado di adattarsi ad ogni tipo di esigenza. In tre colorazioni e in varie misure, questo articolo è la soluzione ideale per lo scarico delle acque meteoriche da terrazze e cornicioni.

Materiale: Marmores.

CLOSED MARMORES DRIP CAP

Commercialized by GRUPPO STAMPLAST the “closed” can suit every need. Available in three colors and in various sizes, this product is ideal for draining rainwater from terraces and ledges.

Material: Marmores (marble-resin).